

## Richter System UW-Profil - Schnitte + Ansichten

Maße in mm - Schemazeichnungen

Richter System SUPERMAGNUM plus UW-Profil 50/40

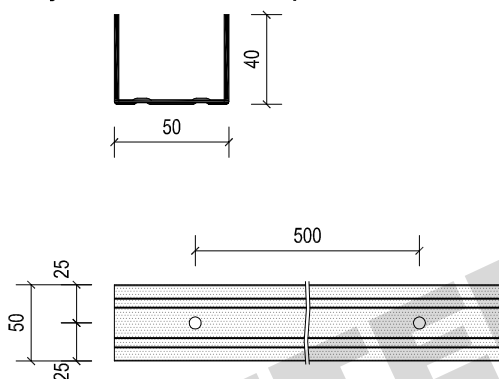

Richter System SUPERMAGNUM plus UW-Profil 75/40

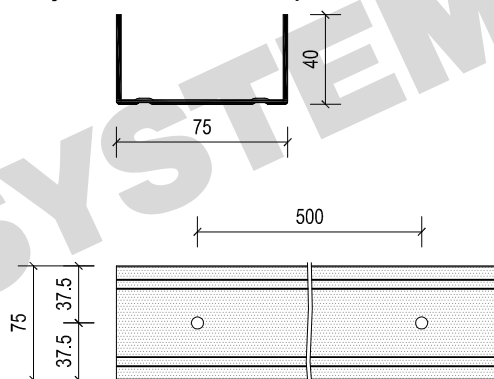

Richter System SUPERMAGNUM plus UW-Profil 100/40

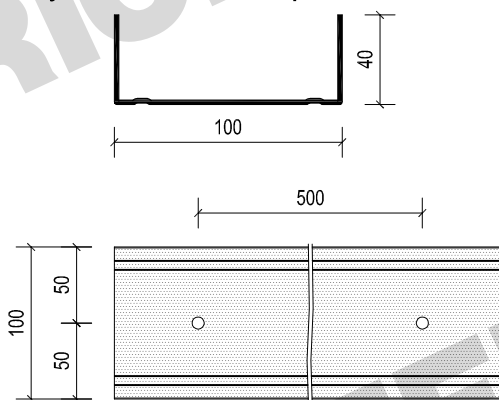

Richter System UW-Profil 125/40

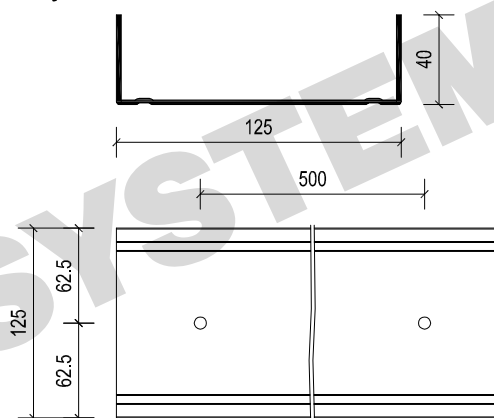

Richter System UW-Profil 150/40

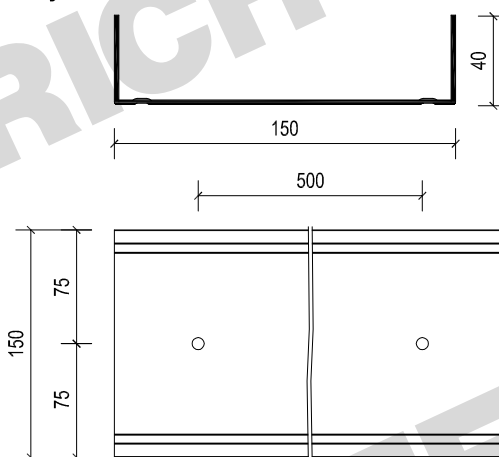

### Materialgüte

#### DX51D+Z100 gemäß DIN EN 10346

- legierter Qualitätsstahl nach EN 10020, Werkstoff-Nr. 1.0226
- Zugfestigkeit:  $\geq 270$  MPa (N/mm<sup>2</sup>)
- Streckgrenze: mind. 240 MPa (N/mm<sup>2</sup>)
- Überzug  $\geq 100$  g/m<sup>2</sup> Zink
- Konformität: DIN 18182-1 / DIN EN 14195

### Profiltyp

Blechdicke: 0,6 mm  $\pm$  0,06

	h [mm]	A [cm <sup>2</sup> ]	I <sub>y</sub> [cm <sup>4</sup> ]	I <sub>z</sub> [cm <sup>4</sup> ]	W <sub>y</sub> [cm <sup>3</sup> ]	W <sub>z</sub> [cm <sup>3</sup> ]
Richter System SUPERMAGNUM plus UW 50 x 40 x 0,6	50	0,72	3,24	1,21	1,30	0,44
Richter System SUPERMAGNUM plus UW 75 x 40 x 0,6	75	0,86	8,01	1,38	2,14	0,47
Richter System SUPERMAGNUM plus UW 100 x 40 x 0,6	100	1,00	15,48	1,50	3,10	0,49
Richter System UW 125 x 40 x 0,6	125	1,14	26,08	1,60	4,17	0,50
Richter System UW 150 x 40 x 0,6	150	1,28	40,25	1,67	5,37	0,51